

EKI-2701HP EKI-2701HPI

IEEE 802.3af/at Gigabit PoE+ Injector

NEW



EKI-2701HP

EKI-2701HPI



Features

- Supports 10/100/1000Base-T (X) for PoE+ OUT and Data IN
- IEEE 802.3af/at compliant, supports a full 30 watt output
- Power input (24 ~ 48 V_{DC}), inject 30 W for each port
- Provides slim size and DIN-rail/Wall mount with IP30 metal mechanism

Introduction

With the technology of PoE (Power over Ethernet), we can transfer both data and electrical power to Ethernet-enabled devices using a standard CAT5 cable. EKI-2701HP/EKI-2701HPI is compliant IEEE 802.3af/at and inject 30W for PD device. This product supports wide power input range between 24 to 48 V_{DC}.

Specifications

Communications

- **Standard** IEEE 802.3, 802.3u, 802.3x, 802.3af/at, 802.3ab
- **LAN** 10/100/1000Base-T (X)
- **Transmission Distance** Up to 100 m (mid-span)
- **Transmission Speed** Up to 1000 Mbps

Interface

- **Connectors** PoE OUT: RJ45
DATA IN: RJ45
6-pin removable screw terminal
- **LED Indicators** PWR1, PWR2, PoE status, Link/Activity

Power

- **Power Consumption** Max. 33.36 W @ 24 V_{DC} (Full load PoE)
- **Power Input** 24 ~ 48 V_{DC}, redundant dual power inputs
- **Power Output** 30 W @ 55 V_{DC}

Mechanism

- **Dimensions (W x H x D)** EKI-2701HP: 30 x 140 x 95 mm (1.18" x 5.51" x 3.74")
EKI-2701HPI: 37 x 140 x 95 mm (1.46" x 5.51" x 3.74")
- **Enclosure** IP30, Metal shell with solid mounting kits
- **Mounting** DIN-rail, Wall

Protection

- **Reverse** Present
- **Overload Current** Present

Environment

- **Operating Temperature** EKI-2701HP: -10 ~ 60°C (-14 ~ 140°F)
EKI-2701HPI: -40 ~ 75°C (-40 ~ 167°F)
- **Storage Temperature** -40 ~ 85°C (-40 ~ 185°F)
- **Operating Humidity** 5 ~ 95% (non-condensing)
- **Storage Humidity** 0 ~ 95% (non-condensing)
- **MTBF** 1,419,817 hours

Certification

- **Safety** UL508 (EKI-2701HPI)
- **EMI** FCC Part 15 Subpart B Class A, EN 55022 Class A
- **EMS** EN 61000-4-2
EN 61000-4-3
EN 61000-4-4
EN 61000-4-5
EN 61000-4-6
EN 61000-4-8
- **Shock** IEC 60068-2-27
- **Freefall** IEC 60068-2-32
- **Vibration** IEC 60068-2-6
- **Patent** <http://www.advantech.com/legal/patent>

Ordering Information

- **EKI-2701HP-AE** PoE+ Injector, supports a full 30 W output
- **EKI-2701HPI-AE** PoE+ Injector, supports a full 30 W output (wide. Temp.)

Dimensions

Unit: [mm]

EKI-2701HP

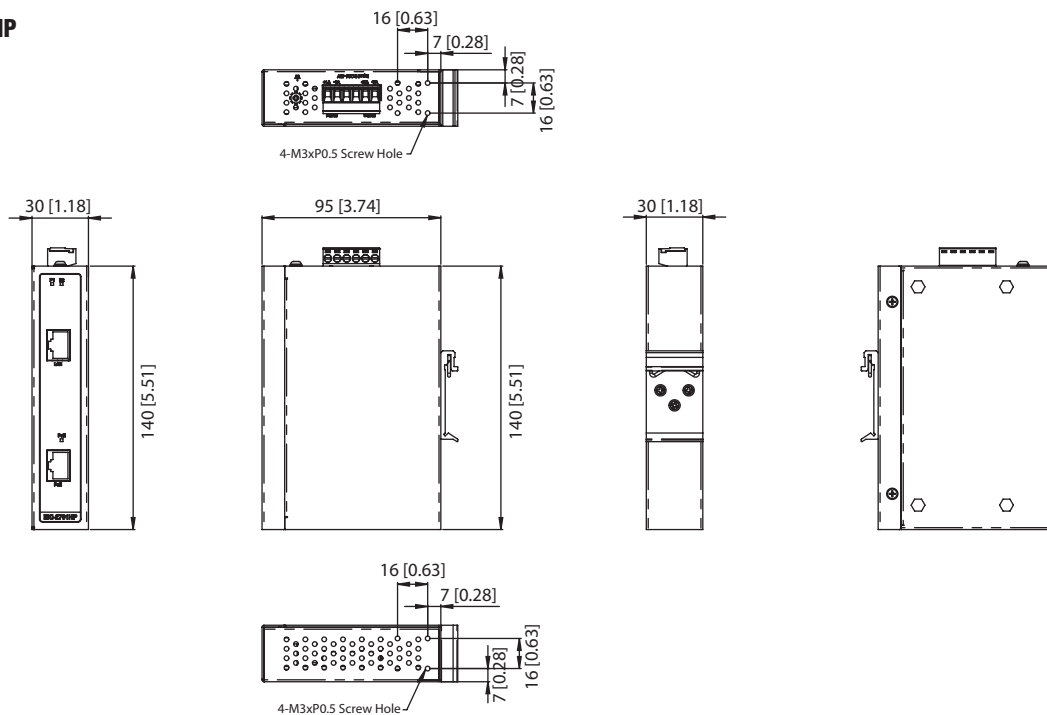

EKI-2701HPI

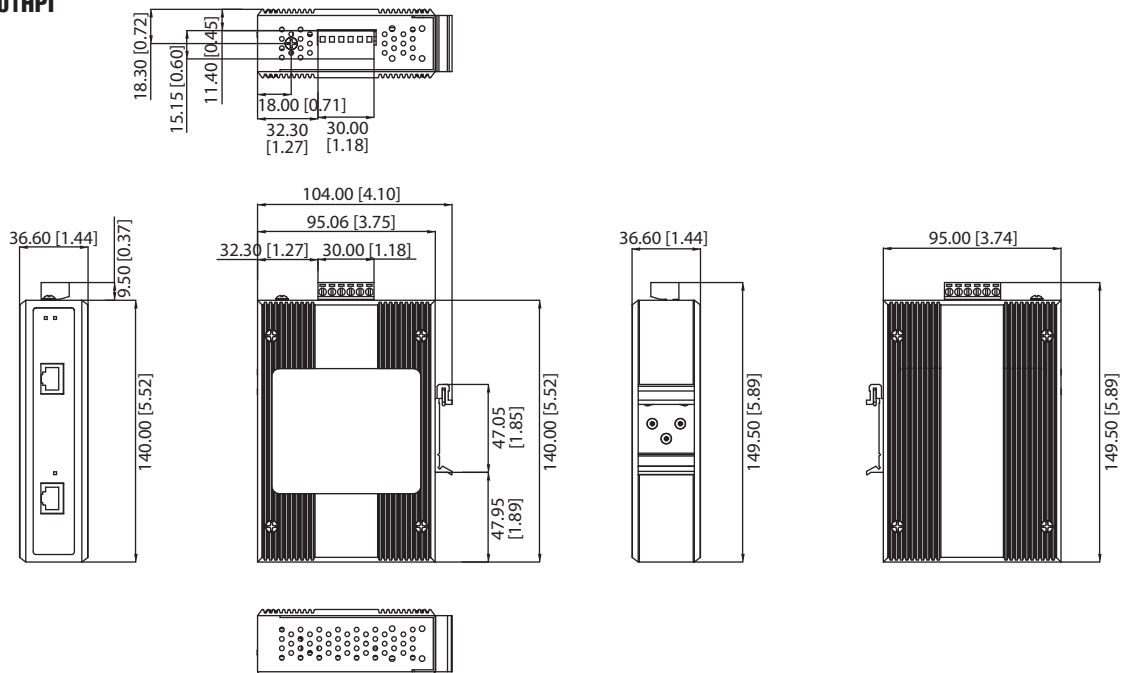

Panel Cut-out Dimensions:

EKI-2701HPI: 37 x 140 x 95 mm (1.46" x 5.51" x 3.74")
 EKI-2701HP: 30 x 140 x 95 mm (1.18" x 5.51" x 3.74")