

IPC-720

Compact Desktop/Wallmount Chassis for ATX/mATX Motherboard

NEW



Features

- Compact wallmount chassis supports up to 7 add-on cards
- Shock resistant 3.5" Drive Bay
- Supports 1 x 3.5" HDD & 2 x 2.5" SSD
- Adjustable hold down bracket with rubber cushion protects the cards from shock and vibration
- Front LED indicators for power status and HDD activity
- Front accessible air filter for easy maintenance

CE FCC

Specifications

		External	Internal
Drive Bay	5.25"	-	0
	3.5"	-	1
	2.5"	-	2
Cooling	Fans	1 (12cm/85CFM) + 1 Optional(12cm/85CFM)	
	Air Filter	Yes	
Miscellaneous	LED Indicators	Power status and HDD activity	
	Control	Power switch and system reset button	
Environment		Operating	Non-Operating
	Temperature	0 ~ 40 °C (32 ~ 104 °F)	-40 ~ 70 °C (-40 ~ 158 °F)
	Humidity	95% @ 40 °C, non-condensing	95% @ 60 °C, non-condensing
	Vibration (5 ~ 500 Hz)	Random 1Grms	Sine 2G
Physical Characteristics	Shock	10 G (with 11 ms duration, half sine wave)	
	Dimensions (W x H x D)	320 x 180 x 321 mm 12.6" x 7.1" x 12.6"	
	Weight	6.99 kg (15.41 lb)	

Front View



Rear View



Inside View



Easy Maintenance Fan Filter

Shock Resistant 3.5" HDD Drive Bay



Adjustable hold down bracket to fix cards with different heights (111 to 127mm)

Default system fan
Optional 2nd system fan



2 x 2.5" SSD install on the left and right sides

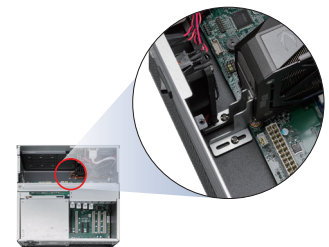

Customizable GPU Tail-End Retainer

* Not included due to GPU dimension/screw holes are different from each other.

Dimensions

Unit: mm

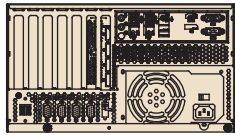

Max. card length: 244mm (9.6")
Max. card height: 127mm (5.0")

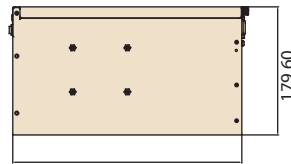
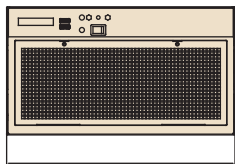
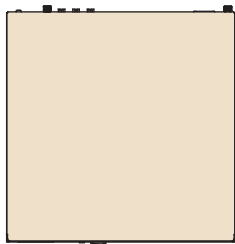

Installation

Unit: mm

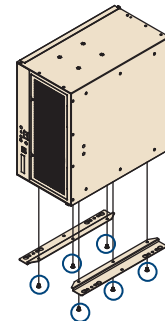
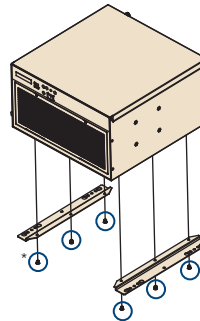
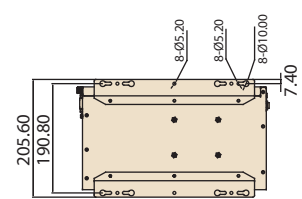
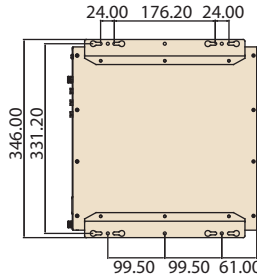

*: Maximum mounting screw length is 6mm. Exceeding this length may cause internal component interference or permanent damage to the chassis.

Ordering Information

Part Number	Power Supply	Wattage	80 Plus
IPC-720-70AEA1	PS8-700ATX-BB	700W	Bronze
IPC-720-50AEA1	PS8-500ATX-BB	500W	Bronze
IPC-720-30DEA1	PS8-300ATX-ZBE	300W	Bronze
IPC-720-00XEA1	-	-	-

Spare Parts

PN	Description	Qty
2130025704N000	System fan filter	1
1960005359T00A	Mounting Bracket	2

Optional Accessories

	PN	PN Description	Qty
Optional 2 nd System fan	1751000748-01	Fan Axial 120x120x26 3000RPM 85CFM	1
	1700030260-01	System fan cable	1
	1962860100	FAN Guard 12*12cm	1
	1939251000	Screw T5x10L S/S D=6.3 H=1.2 (2+) ST Ni	8
PSU Bracket for 150mm-depth PSU	1960120585N010	IPC-720 PSU bracket, for 150mm-depth 850W PSU PS8-850ATX-GZ	1
Expansion Card Hold-down Bracket (4pcs hold down brackets are included in each IPC-720)	1960120584N000	Hold-down bracket for IPC-720	1
	199002K000	Rubber Spacer 14*14*2mm	1
	1930007122-01	Thumb Screw M4*5L SP/S D=9.0 H=6.5 (+-) ST WZn	1
GPU Tail-End Retainer (For Dual-Fan RTX 5060, RTX 5070)	1960100024N110	GPU Retainer for Dual-Fan RTX 5060, RTX 5070	1
	1933030500	Screw M3x5L 1/4R/S D=6.9 H=1.9 (2+) ST Ni	4
SSD Bracket	989K008734	Module to fix two 2.5" HDDs in 3.5" bay	1